

NOTICE: RESTRICTED AS TO USE AND DISCLOSURE

THIS ENTIRE DOCUMENT AND ALL INFORMATION IS PROPRIETARY TO COLT INC. AND SHALL NOT BE REPRODUCED, DUPLICATED OR COPIED IN WHOLE OR IN PART, DISCLOSED OR MADE AVAILABLE TO ANY OTHER PERSON, FIRM, OR CORPORATION OR OTHERWISE USED EXCEPT TO THE EXTENT NECESSARY FOR AND THEN ONLY IN CONNECTION WITH THE PREPARATION CONNECTION WITH THE PREPARATION AND/OR SUBMISSION OF BIDS OR PROPOSALS RELATED TO A PROCUREMENT BEING EFFECTED BY THE UNITED STATES EITHER BY THE UNITED STATES GOVERNMENT OR UNDER CONTRACT WITH THE UNITED STATES GOVERNMENT. THIS DOCUMENT WILL BE DISPOSED OF IN ACCORDANCE WITH THE INSTRUCTIONS ISSUED BY THE RESPONSIBLE CONTRACTING OFFICER UPON COMPLETION OF THE PURPOSE FOR WHICH IT WAS ISSUED.

SPECIAL LICENSE RIGHTS  
 THE GOVERNMENT'S RIGHTS TO USE, MODIFY, REPRODUCE, RELEASE, PERFORM, DISPLAY, OR DISCLOSE THESE DATA ARE RESTRICTED BY CONTRACT NO. DAAF03-67-C-108, LICENSE NO. DAAF03-67-C-108. ANY REPRODUCTION OF TECHNICAL DATA OR PORTIONS THEREOF MARKED WITH THIS LEGEND MUST ALSO REPRODUCE THE MARKINGS.

DUE TO GOVERNMENT GENERATED ENGINEERING CHANGES, THERE MAY BE DATA AND/OR TOLERANCES NOT PROPRIETARY TO COLT'S.

REVISIONS				
MODEL REV	DRAW REV	DESCRIPTION	DATE(YEAR-MO-DA)	APPROVED
N/A	E	NOR GIS2018 / 1991-07-08	1991-08-11	
N/A	F	NOR G2S3025 / 1992-03-30	1992-04-27	
-	G	NOR LIS3067 / 2002-03-26	2002-05-23	JJW
A	H	NOR L04S5165 / 2004-11-15	2005-01-04	RJC
B	J	NOR L08S3013 / 2008-03-25	2008-04-23	BMG

NOTES

1. MIL-W-13855 APPLIES.

2. MATERIAL: TOOL STEEL, TYPE S1 TO S7 PER ASTM A 681.

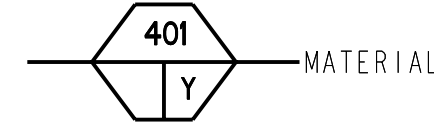

3. SURFACE FINISH: 125/ EXCEPT AS NOTED.

4. BREAK SHARP EDGES R.010 MAX.

5. HEAT TREAT PER ASTM A 681. HEAT TREATMENT METHODS ARE FOR GUIDANCE ONLY, EXCEPT THAT TEMPERING TIMES SHALL NOT BE REDUCED BELOW THOSE SPECIFIED.

6. AFTER TEMPERING, STEEL SHOT PEEN ALL OVER, S-70 SHOT, .005<sup>+</sup>.002<sup>-</sup> -A2 ALMEN, 150% APPROX COVERAGE.

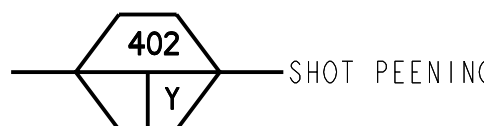

7. HARDNESS: EQUIVALENT TO ROCKWELL 15N 88.5 TO 90.5.

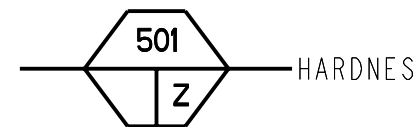

8. CLEAN PER TT-C-490, METHOD III OR IV.

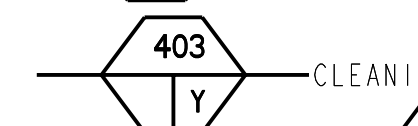

9. PROTECTIVE FINISH: FINISH 5.3.1.2 OF MIL-STD-171.

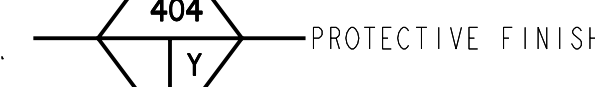

10. QUALITY ASSURANCE PROVISION REQUIREMENTS PER DRAWING NUMBER 12993884 APPLY.

- MISSING OR DEFECTIVE PROTECTIVE FINISH
- WORKMANSHIP
- SALT SPRAY TEST
- COATING WEIGHT
- SUPPLEMENTARY OIL TREATMENT, SALT SPRAY TEST

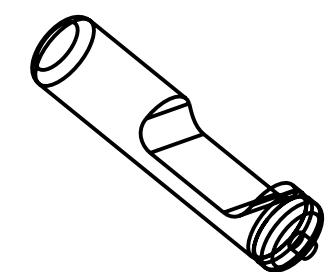

ISOMETRIC VIEW  
SCALE 4.000

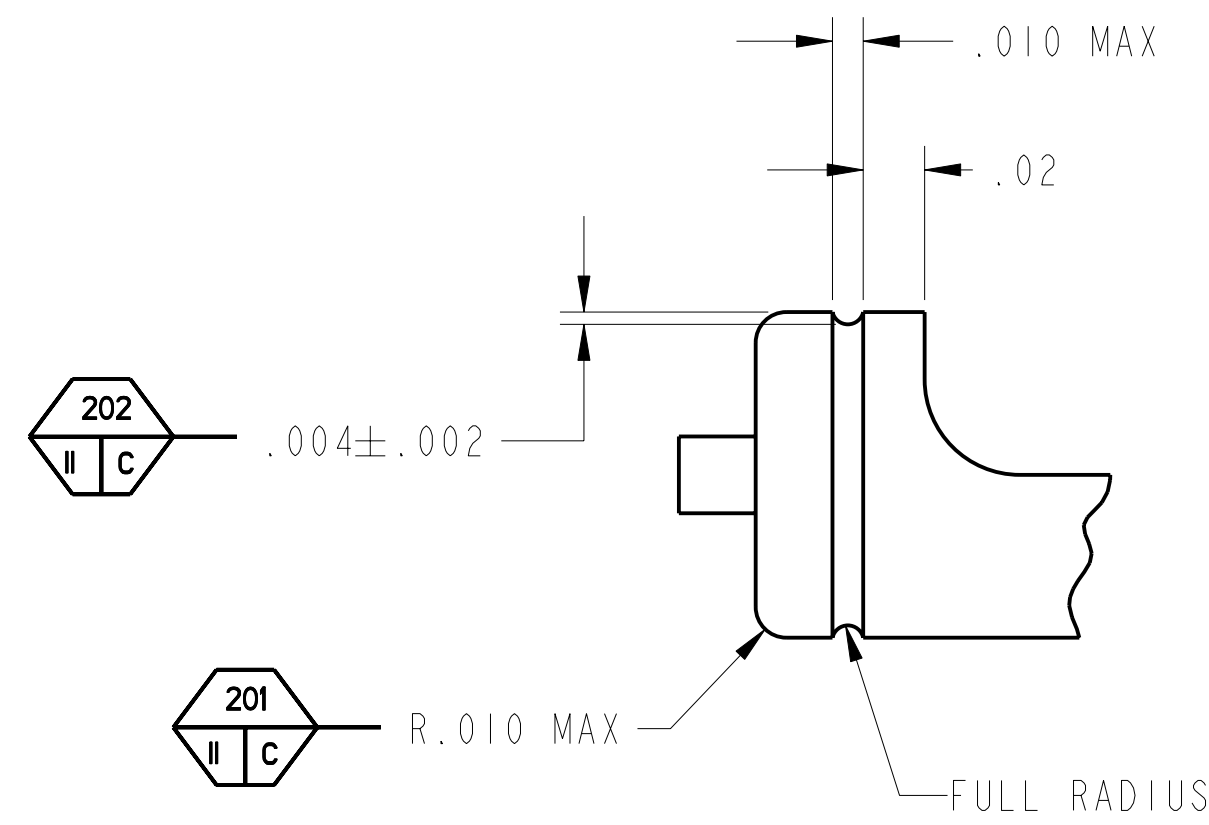

DETAIL A  
SCALE 16.000

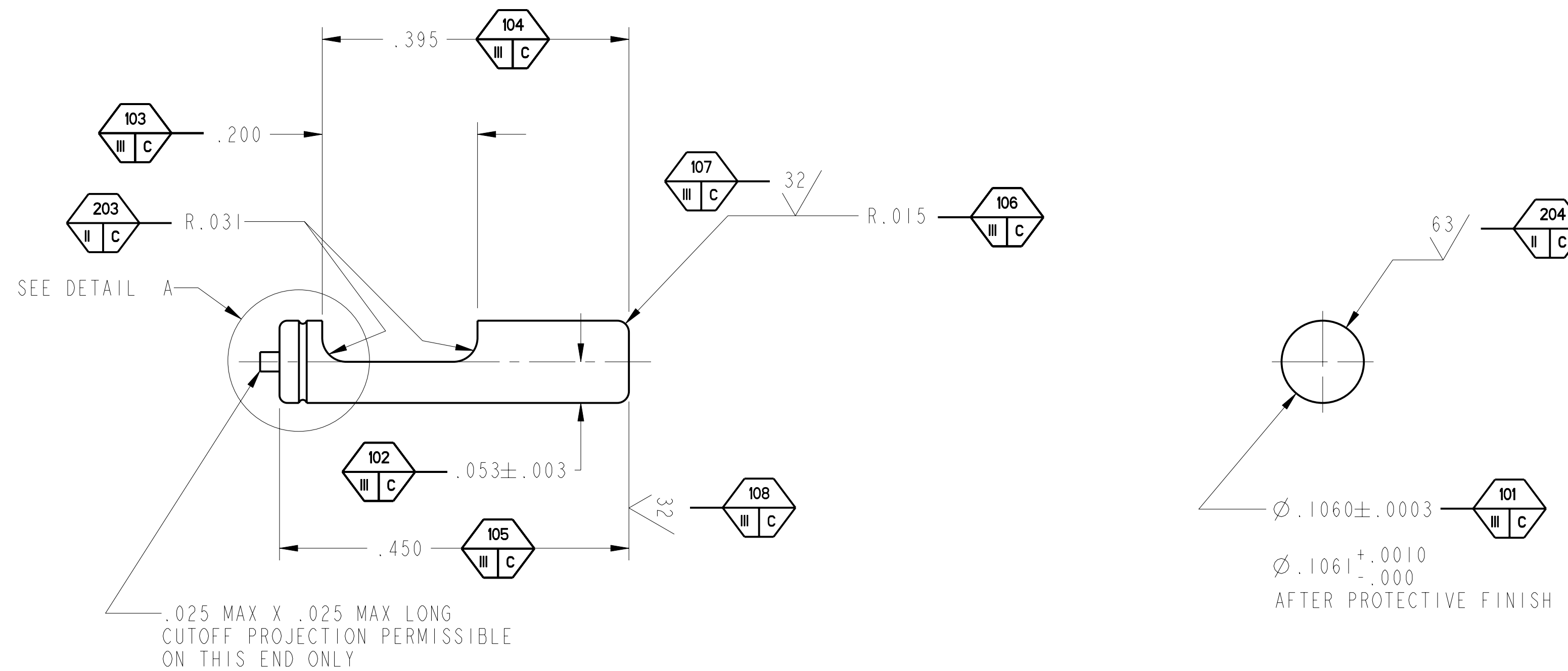

THIS DRAWING WAS GENERATED FROM A SOLID MODEL AND IS CAD MAINTAINED. CHANGES SHALL BE INCORPORATED BY THE DESIGN ACTIVITY.

CURRENT DESIGN ACTIVITY CAGE CODE 19200  
 US ARMY  
 ARMAMENT RESEARCH, DEVELOPMENT AND ENGINEERING CENTER  
 PICATINNY ARSENAL, NEW JERSEY 07806-5000

PART NO. 8448515

DISTRIBUTION STATEMENT F.  
 FURTHER DISTRIBUTION ONLY AS DIRECTED BY US ARMY ARDEC, AMSTA-AR-CCL-F, ROCK ISLAND, IL; 1993-09-14.

PMIC	M231	DO NOT SCALE DRAWING UNLESS OTHERWISE SPECIFIED DIMENSIONS ARE IN INCHES	CONTRACT NUMBER		DESIGN ACTIVITY US ARMY ROCK ISLAND ARSENAL ROCK ISLAND, ILLINOIS
	M4A1		CONTRACTOR		
MECHANICAL PROPERTIES	M4A	TOLERANCES ON ANGLES ± 2° 2 PLACE DECIMALS ± .01 3 PLACE DECIMALS ± .005	DRAWN BY G. STRAHL	DATE(YEAR-MO-DA) 1970-04-27	EJECTOR
	M16A4		CHECKER J. WINDHAM	ENGINEER J. WINDHAM	
YP	12972691	THIRD ANGLE PROJECTION	ENGINEER L. KO	QUALITY ENGINEER L. CICHUCKI	SIZE D
TS	9327073		DRAWING APPROVAL L. BRUNTON	2002-03-21	
EL2	8448509	MATL ENGR G. STRAHL	MODELED BY R. ELBE	DESIGN APPROVAL R. ELBE	DWG NO. 8448515
RA	NEXT ASSY	USED ON			SCALE 8.000
BH	APPLICATION				UNIT WT. 0.000903
RH					SHEET 1 OF 1