

NOTICE: RESTRICTED AS TO USE AND DISCLOSURE

THIS ENTIRE DOCUMENT AND ALL INFORMATION IS PROPRIETARY TO COLT INC. AND SHALL NOT BE REPRODUCED, DUPLICATED OR COPIED IN WHOLE OR IN PART, DISCLOSED OR MADE AVAILABLE TO ANY OTHER PERSON, FIRM, OR CORPORATION OR OTHERWISE USED EXCEPT TO THE EXTENT NECESSARY FOR AND THEN ONLY IN CONNECTION WITH THE PREPARATION CONNECTION WITH THE PREPARATION AND/OR SUBMISSION OF BIDS OR PROPOSALS RELATED TO A PROCUREMENT BEING EFFECTED BY THE UNITED STATES EITHER BY THE UNITED STATES GOVERNMENT OR UNDER CONTRACT WITH THE UNITED STATES GOVERNMENT. THIS DOCUMENT WILL BE DISPOSED OF IN ACCORDANCE WITH THE INSTRUCTIONS ISSUED BY THE RESPONSIBLE CONTRACTING OFFICER UPON COMPLETION OF THE PURPOSE FOR WHICH IT WAS ISSUED.

SPECIAL LICENSE RIGHTS  
THE GOVERNMENT'S RIGHTS TO USE, MODIFY, REPRODUCE, RELEASE, PERFORM, DISPLAY, OR DISCLOSE THESE DATA ARE RESTRICTED BY CONTRACT NO. DAAF03-67-C-108, LICENSE NO. DAAF03-67-C-108. ANY REPRODUCTION OF TECHNICAL DATA OR PORTIONS THEREOF MARKED WITH THIS LEGEND MUST ALSO REPRODUCE THE MARKINGS.

DUE TO GOVERNMENT GENERATED ENGINEERING CHANGES, THERE MAY BE DATA AND/OR TOLERANCES NOT PROPRIETARY TO COLT'S.

| REVISIONS |          |                           |                  |          |
|-----------|----------|---------------------------|------------------|----------|
| MODEL REV | DRAW REV | DESCRIPTION               | DATE(YEAR-MO-DA) | APPROVED |
| N/A       | D        | NOR GIS2018 / 1991-07-08  | 1991-10-11       | RR       |
| N/A       | E        | NOR G6S3135 / 1996-09-26  | 1996-10-30       | DR       |
| -         | F        | NOR LIS3057 / 2001-11-19  | 2002-06-12       | JJW      |
| A         | G        | NOR L06S3020 / 2006-03-29 | 2006-05-02       | BMG      |
| B         | H        | NOR L08S3013 / 2008-03-25 | 2008-04-23       | BMG      |

B

NOTES

- MIL-W-13855 APPLIES.
- MATERIAL: STAINLESS STEEL, TYPE 302, 304, OR 321 PER ASTM A 580, CONDITION A OR PER ASTM A 484.
- PROTECTIVE FINISH: FINISH 5.4.1 OF MIL-STD-171.
- SURFACE FINISH: 125/ EXCEPT AS NOTED.
- QUALITY ASSURANCE PROVISION REQUIREMENTS PER DRAWING NUMBER 12993884 APPLY.

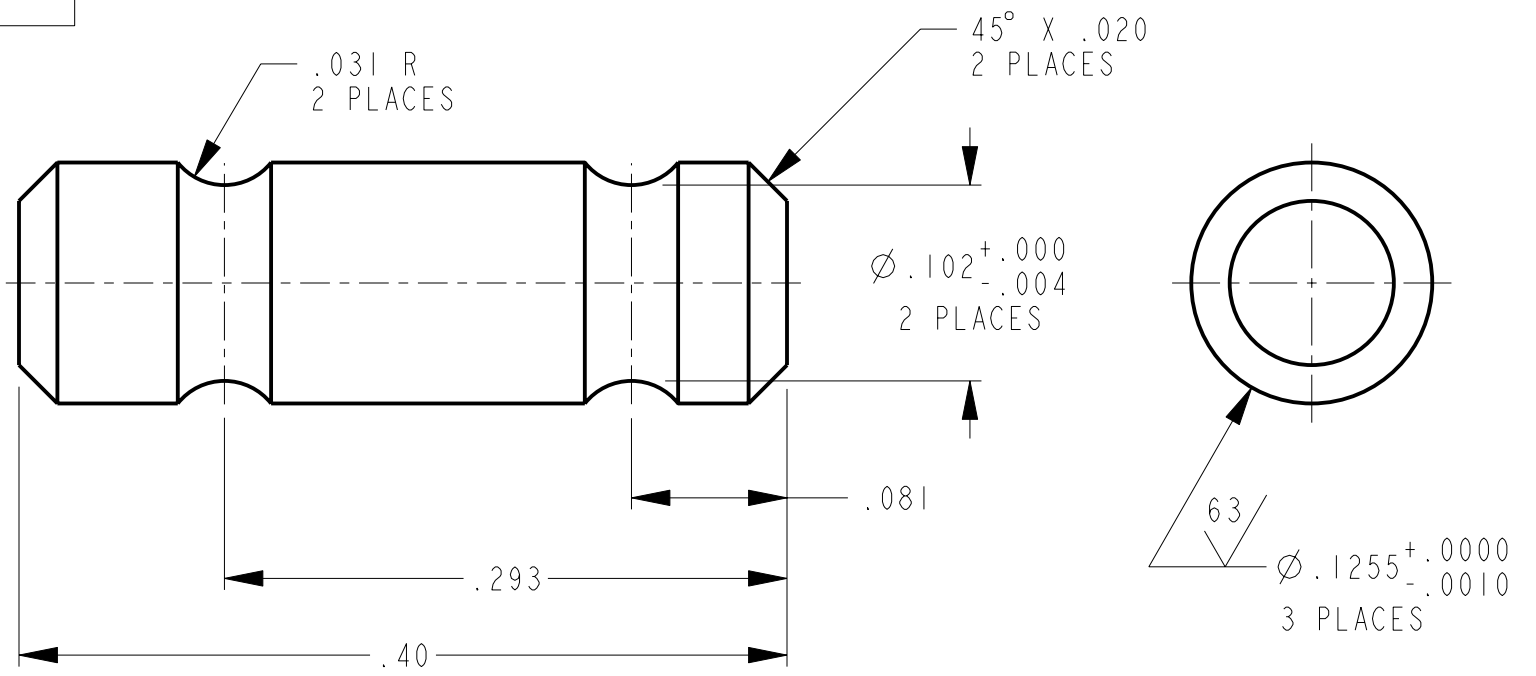
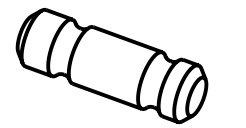
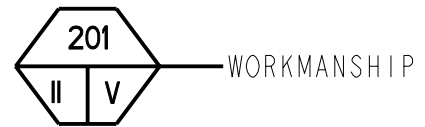
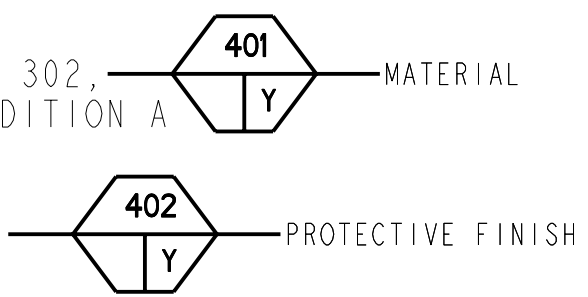

THIS DRAWING WAS GENERATED FROM A SOLID MODEL AND IS CAD MAINTAINED. CHANGES SHALL BE INCORPORATED BY THE DESIGN ACTIVITY.

DISTRIBUTION STATEMENT F.  
FURTHER DISTRIBUTION ONLY AS DIRECTED BY US ARMY ARDEC;  
AMSTA-AR-CCL-F, ROCK ISLAND, IL; 1993-09-14.

CURRENT DESIGN ACTIVITY CAGE CODE 19200  
US ARMY  
ARMAMENT RESEARCH, DEVELOPMENT AND ENGINEERING CENTER  
PICATINNY ARSENAL, NEW JERSEY 07806-5000

**PART NO. 8448570**

A

|                       |         |             |   |            |                       |                   |   |           |         |
|-----------------------|---------|-------------|---|------------|-----------------------|-------------------|---|-----------|---------|
| PMIC                  |         |             | DO NOT SCALE DRAWING                                    |            | CONTRACT NUMBER       |                   | DESIGN ACTIVITY   |           |         |
| MECHANICAL PROPERTIES |         |             | UNLESS OTHERWISE SPECIFIED ALL DIMENSIONS ARE IN INCHES |            | CONTRACTOR            |                   | US ARMY<br>ROCK ISLAND ARSENAL<br>ROCK ISLAND, ILLINOIS |           |         |
| YP                    |         | M4A1        | TOLERANCE ON ANGLES ± 2°                                |            | DRAWN BY              | DATE (YEAR-MO-DA) | PLUG, GAS TUBE  |           |         |
| TS                    |         | M4          | 2 PLACE DECIMALS ± .01                                  |            | G. STRAHL             | 1970-04-27        |   |           |         |
| EL2                   |         | M16A4       | 3 PLACE DECIMALS ± .005                                 |            | CHECKER               | ENGINEER          |   |           |         |
| RA                    | 8448568 | M16A3       | THIRD ANGLE PROJECTION                                  |            | S. GALL - ESERV       | J. WINDHAM        |   |           |         |
| BH                    | 9390017 | M16A2       |   |            | L. KO                 | QUALITY ENGINEER  |   |           |         |
| RH                    |         | M16A1       |   |            | DRAWING APPROVAL      |                   | SIZE  | CAGE CODE | DWG NO. |
|                       |         | NEXT ASSY   |   |            | L. BRUNTON 2001-11-16 |                   | <b>B</b>  | 19204     | 8448570 |
|                       |         | USED ON     |   |            | DESIGN APPROVAL       |                   | SCALE   | UNIT WT   | SHEET   |
|                       |         | APPLICATION |   |            | R. ELBE 2001-11-16    |                   | 10.000  | 0.00131   | 1 OF 1  |
|                       |         |             | MATL ENGR   | MODELED BY |                       |                   |   |           |         |
|                       |         |             |   | G. STRAHL  |                       |                   |   |           |         |