

NOTICE: RESTRICTED AS TO USE AND DISCLOSURE
 THIS ENTIRE DOCUMENT AND ALL INFORMATION IS PROPRIETARY TO COLT INC. AND SHALL NOT BE REPRODUCED, DUPLICATED OR COPIED IN WHOLE OR IN PART, DISCLOSED OR MADE AVAILABLE TO ANY OTHER PERSON, FIRM, OR CORPORATION OR OTHERWISE USED EXCEPT TO THE EXTENT NECESSARY FOR AND THEN ONLY IN CONNECTION WITH THE PREPARATION CONNECTION WITH THE PREPARATION AND/OR SUBMISSION OF BIDS OR PROPOSALS RELATED TO A PROCUREMENT BEING EFFECTED BY THE UNITED STATES EITHER BY THE UNITED STATES GOVERNMENT OR UNDER CONTRACT WITH THE UNITED STATES GOVERNMENT. THIS DOCUMENT WILL BE DISPOSED OF IN ACCORDANCE WITH THE INSTRUCTIONS ISSUED BY THE RESPONSIBLE CONTRACTING OFFICER UPON COMPLETION OF THE PURPOSE FOR WHICH IT WAS ISSUED.

SPECIAL LICENSE RIGHTS
 THE GOVERNMENT'S RIGHTS TO USE, MODIFY, REPRODUCE, RELEASE, PERFORM, DISPLAY, OR DISCLOSE THESE DATA ARE RESTRICTED BY CONTRACT NO. DAF03-97-C-108, LICENSE NO. DAF03-97-C-108. ANY REPRODUCTION OF TECHNICAL DATA OR PORTIONS THEREOF MARKED WITH THIS LEGEND MUST ALSO REPRODUCE THE MARKINGS.

NOTES
 DUE TO GOVERNMENT GENERATED ENGINEERING CHANGES, THERE MAY BE DATA AND/OR TOLERANCES NOT PROPRIETARY TO COLT'S.

- NOTES**
- ALUMINUM ALLOY, 7075, FORGE PER AMS-QQ-A-367 TO COND'TN T6, MIN BRINELL HARDNESS 135 WITH 500 KG LOAD.
 - DRAFT ANGLE $4^\circ \pm 2^\circ$ UNLESS OTHERWISE SPECIFIED.
 - EDGE RADII R.062^{+.020}/_{-.010}
 - FILLET RADII R.08-.03 EXCEPT AS NOTED.
 - FLASH EXT 0.03 MAX.
 - ANGULAR $\pm 0^\circ 30'$.
 - MISMATCH 0.02 MAX.
 - ALL RADII TOLERANCE TO BE $^{+.020}$ /_{-.010}.
 - ALL LINEAR DIMENSIONAL TOLERANCES ARE $^{+.03}$ AND $^{-.01}$.
 - FORGING MUST BE FREE OF BLEMISHES CAUSED BY ROUGH HANDLING DURING FABRICATION.
 - FORGED SURFACE ROUGHNESS TO BE 125/
 - PLANE **-B-** ESTABLISHED BY ϕ OF **-X-**, **-Y-**, AND **-Z-**.
 - ALL DIMENSIONS APPLY TO THEORETICAL SHARP CORNERS.
 - MIL-W-13855 APPLIES.
 - QUALITY ASSURANCE PROVISION REQUIREMENTS PER DRAWING 12993884 APPLY.

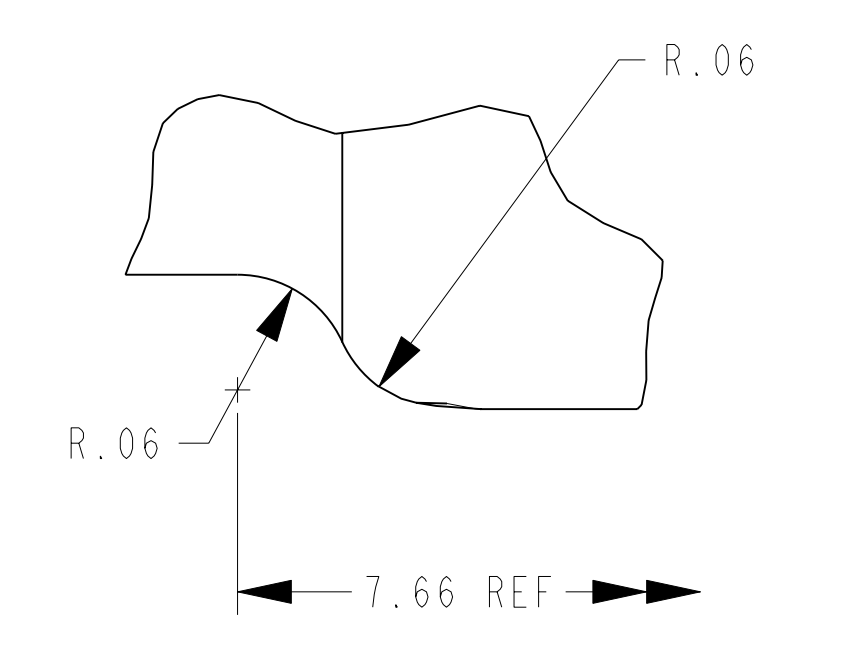
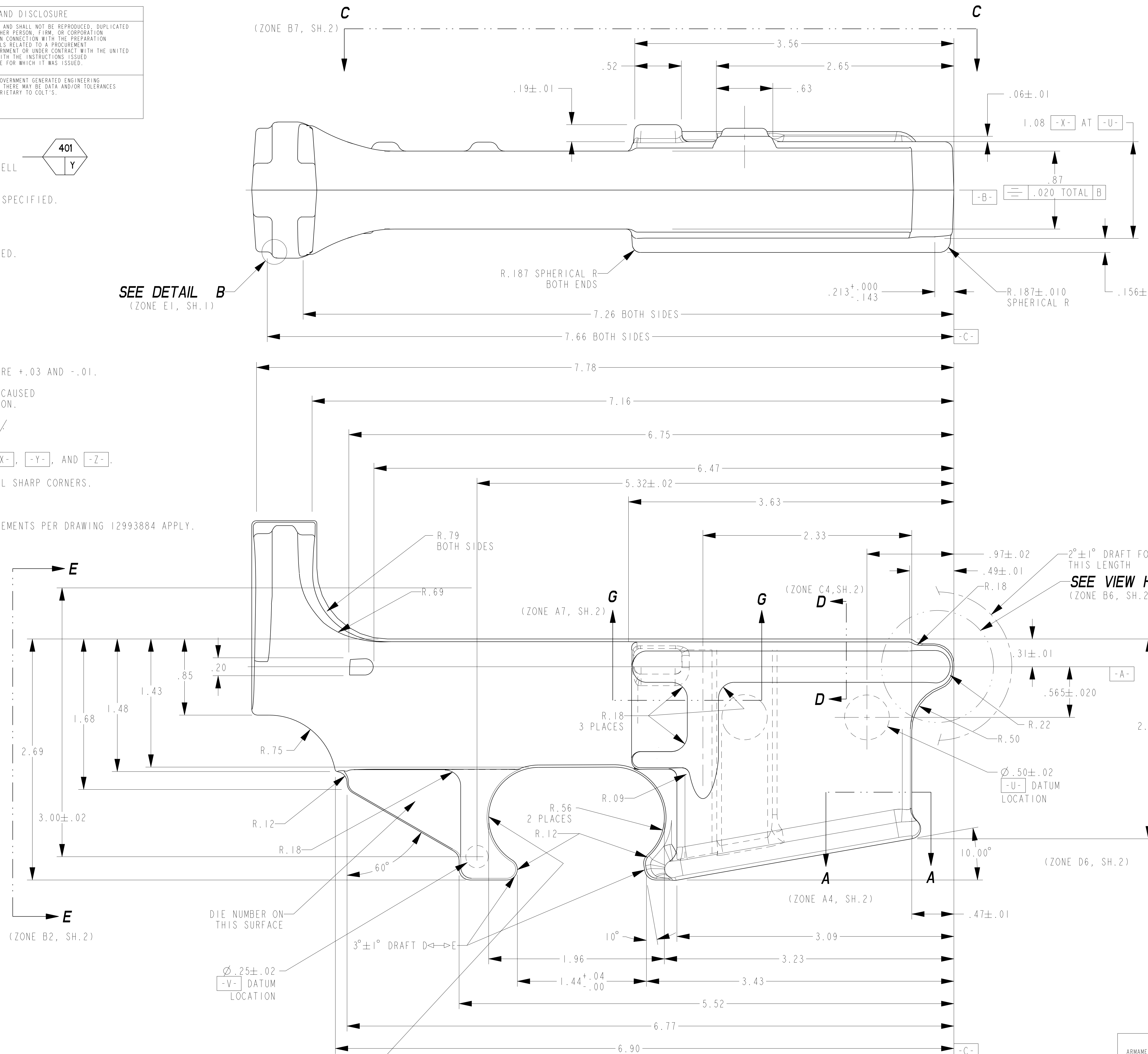
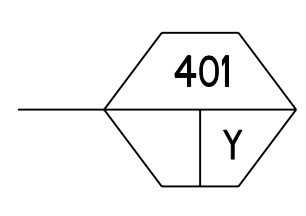

REVISIONS				
MODEL REV	DRAWING REV	DESCRIPTION	DATE(YEAR-MO-DA)	APPROVED
N/A	L	NOR G1S2018 / 1991-07-08	1991-10-11	RR
N/A	M	NOR G1S3089 / 1991-07-16	1992-02-06	GHS
N/A	N	NOR G3S3059 / 1993-07-07	1993-09-01	RLV
N/A	P	NOR G3S3063 / 1993-07-15	1994-11-28	HJS
N/A	R	NOR L1S2102 / 2001-08-23	2001-09-26	RLV
-	T	NOR L2S3042 / 2002-08-05	2002-09-26	JJW
A	U	NOR L3S3161 / 2004-03-31	2004-08-13	RLV

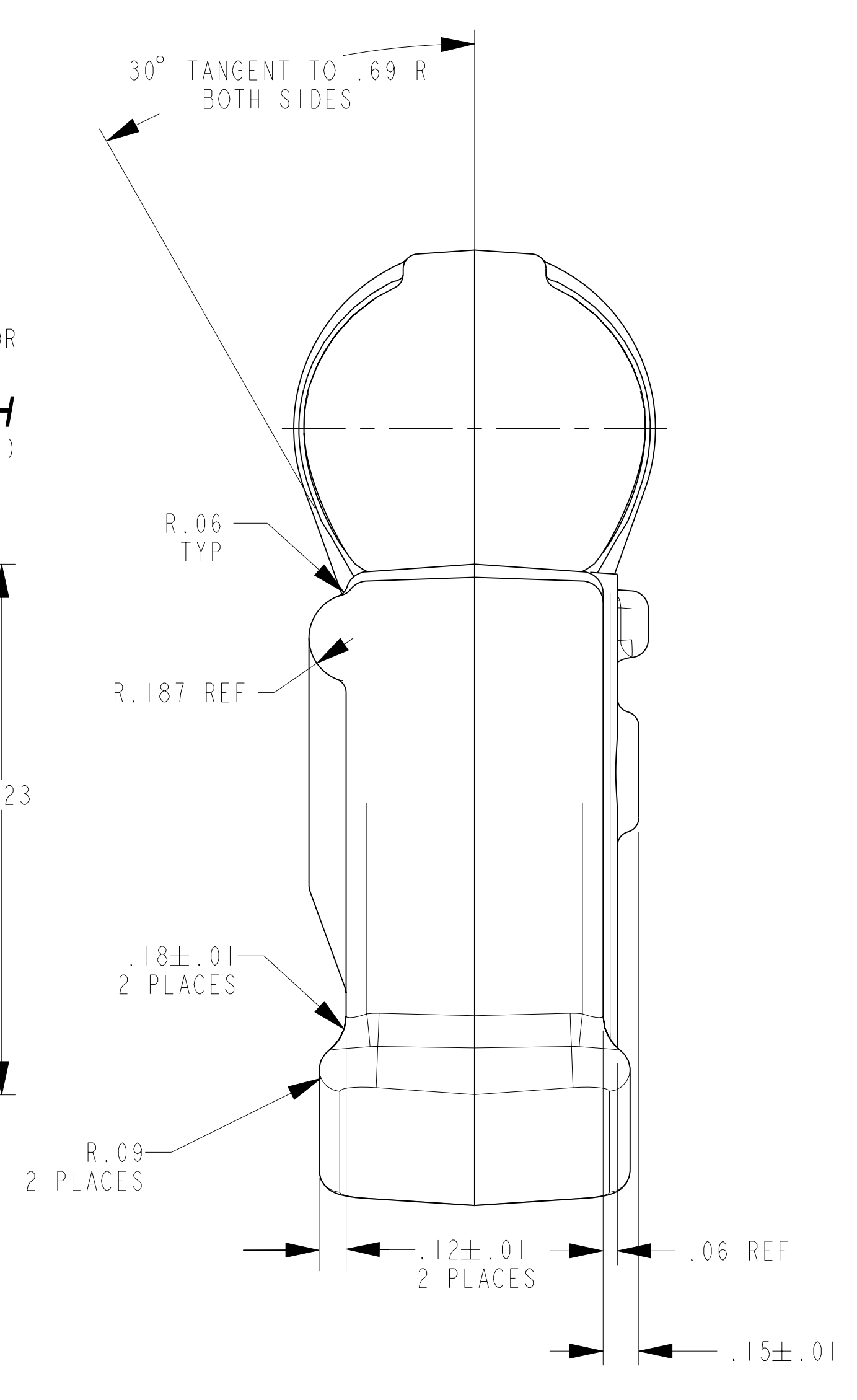

REV STATUS OF SHEETS	REV	U	U
	SHEET	1	2

THIS DRAWING WAS GENERATED FROM A SOLID MODEL AND IS CAD MAINTAINED. CHANGES SHALL BE INCORPORATED BY THE DESIGN ACTIVITY.

CURRENT DESIGN ACTIVITY CAGE CODE 19200
 US ARMY
 ARMAMENT RESEARCH, DEVELOPMENT AND ENGINEERING CENTER
 PISCATAWAY ARSENAL, NEW JERSEY 07806-5000

PART NO. 8448641

PMIC	M231	DO NOT SCALE DRAWING UNLESS OTHERWISE SPECIFIED DIMENSIONS ARE IN INCHES	CONTRACT NUMBER	DESIGN ACTIVITY
	M4A1			
MECHANICAL PROPERTIES	M4	TOLERANCES ON ANGLES \pm 2 PLACE DECIMALS \pm 3 PLACE DECIMALS \pm	CONTRACTOR	DRAWN BY D. NELSON-ESERV 1970-04-27
	8448608			
YP	F9327036	M16A3	ENGINEER	DATE (YEAR-MO-DA) 1970-04-27
TS		M16A2	ENGINEER	J. WINDHAM
EL2		M16A1	ENGINEER	E. SESE
RA			QUALITY ENGINEER	
BH	F8448608	M16A1	ENGINEER	
RH			ENGINEER	
	NEXT ASSY	USED ON	MATL ENGR	MODELED BY
			J. LOWDER-ESERV	R. ELBE
	APPLICATION			

DISTRIBUTION STATEMENT F: FURTHER DISTRIBUTION ONLY AS DIRECTED BY US ARMY; ARDEC, AMSTA-AR-CCL-F, ROCK ISLAND, IL; 1993-09-14.

NOTICE: RESTRICTED AS TO USE AND DISCLOSURE

THIS ENTIRE DOCUMENT AND ALL INFORMATION IS PROPRIETARY TO COLT INC. AND SHALL NOT BE REPRODUCED, DUPLICATED OR COPIED IN WHOLE OR IN PART, DISCLOSED OR MADE AVAILABLE TO ANY OTHER PERSON, FIRM, OR CORPORATION OR OTHERWISE USED EXCEPT TO THE EXTENT NECESSARY FOR AND THEN ONLY IN CONNECTION WITH THE PREPARATION CONNECTION WITH THE PREPARATION AND/OR SUBMISSION OF BIDS OR PROPOSALS RELATED TO A PROCUREMENT BEING EFFECTED BY THE UNITED STATES EITHER BY THE UNITED STATES GOVERNMENT OR UNDER CONTRACT WITH THE STATES GOVERNMENT. THIS DOCUMENT WILL BE DISPOSED OF IN ACCORDANCE WITH THE INSTRUCTIONS ISSUED BY THE RESPONSIBLE CONTRACTING OFFICER UPON COMPLETION OF THE PURPOSE FOR WHICH IT WAS ISSUED.

SPECIAL LICENSE RIGHTS
 THE GOVERNMENT'S RIGHTS TO USE, MODIFY, REPRODUCE, RELEASE, PERFORM, DISPLAY, OR DISCLOSE THESE DATA ARE RESTRICTED BY CONTRACT NO. DAA03-67-C-108. LICENSE NO. DAA03-67-C-108. ANY REPRODUCTION OF TECHNICAL DATA OR PORTIONS THEREOF MARKED WITH THIS LEGEND MUST ALSO REPRODUCE THE MARKINGS.

DUE TO GOVERNMENT GENERATED ENGINEERING CHANGES, THERE MAY BE DATA AND/OR TOLERANCES NOT PROPRIETARY TO COLT'S.

MODEL REV		DRAWING REV		REVISIONS	DATE(YEAR-MO-DA)	APPROVED
				DESCRIPTION		
N/A	M	NOR	G1S3089	/	1991-07-16	GHS
N/A	N	NOR	G3S3059	/	1993-07-07	RLV
-	T	NOR	L2S3042	/	2002-08-05	JJW
A	U	NOR	L3S3161	/	2004-03-31	RLV

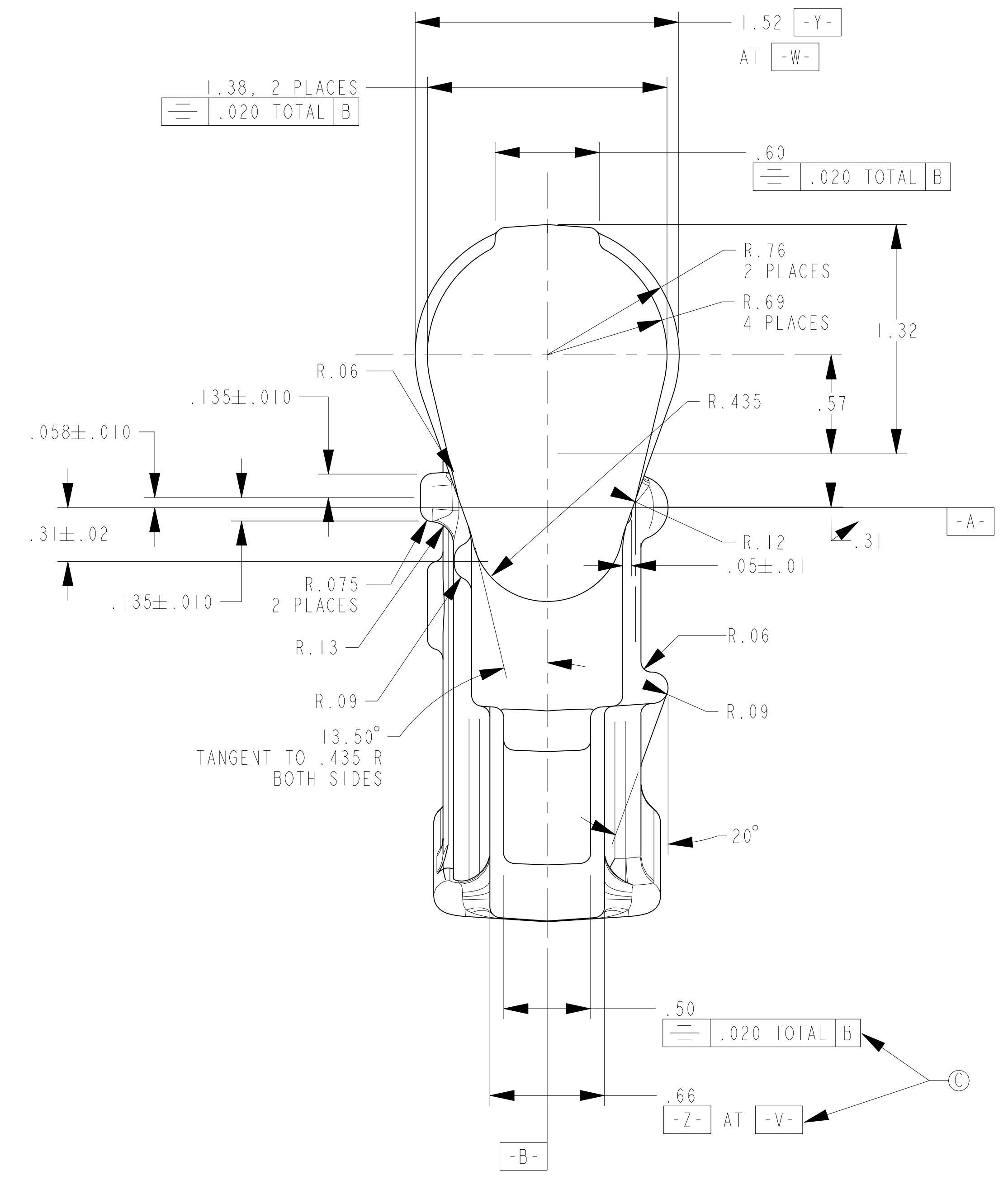
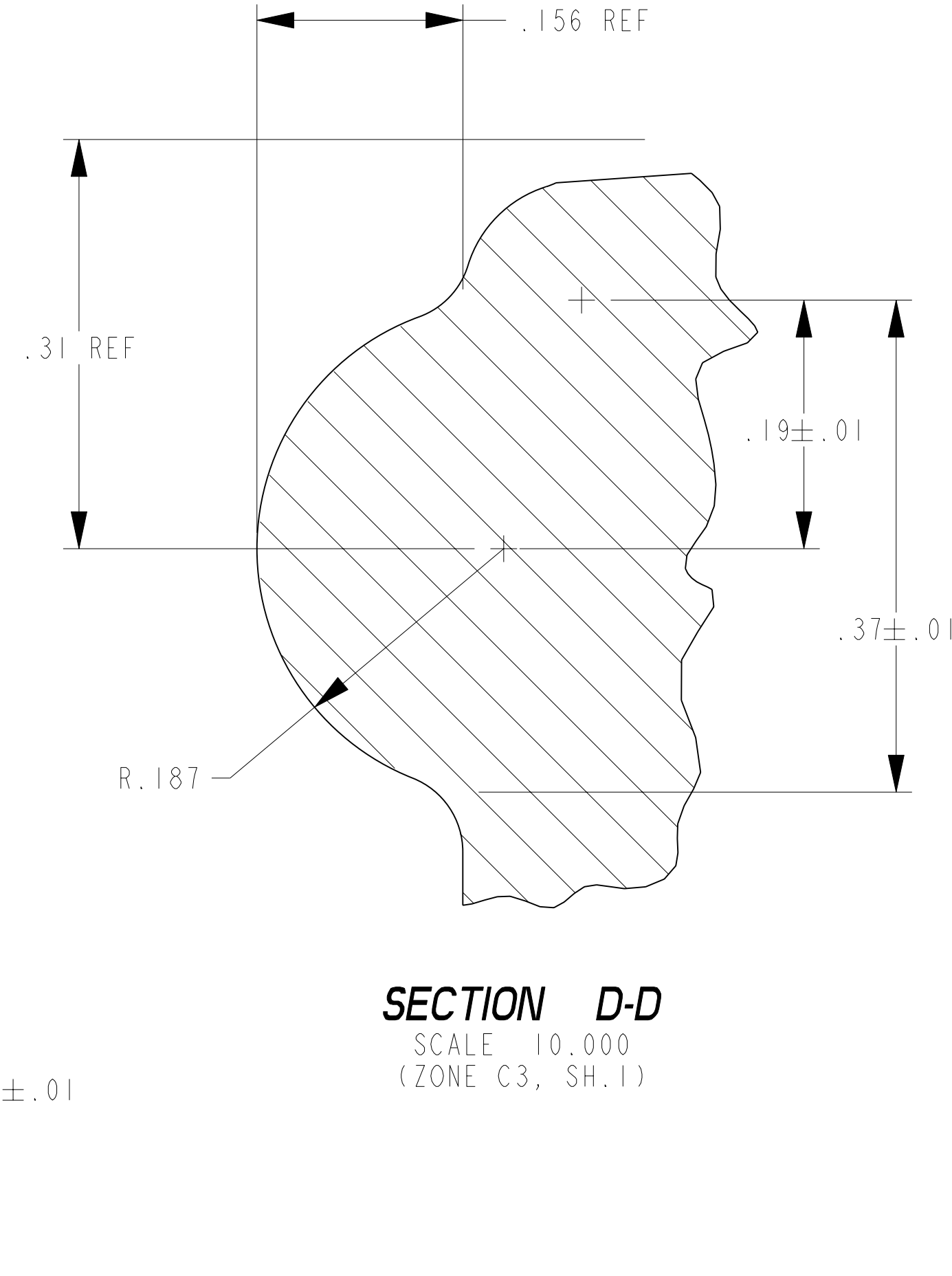
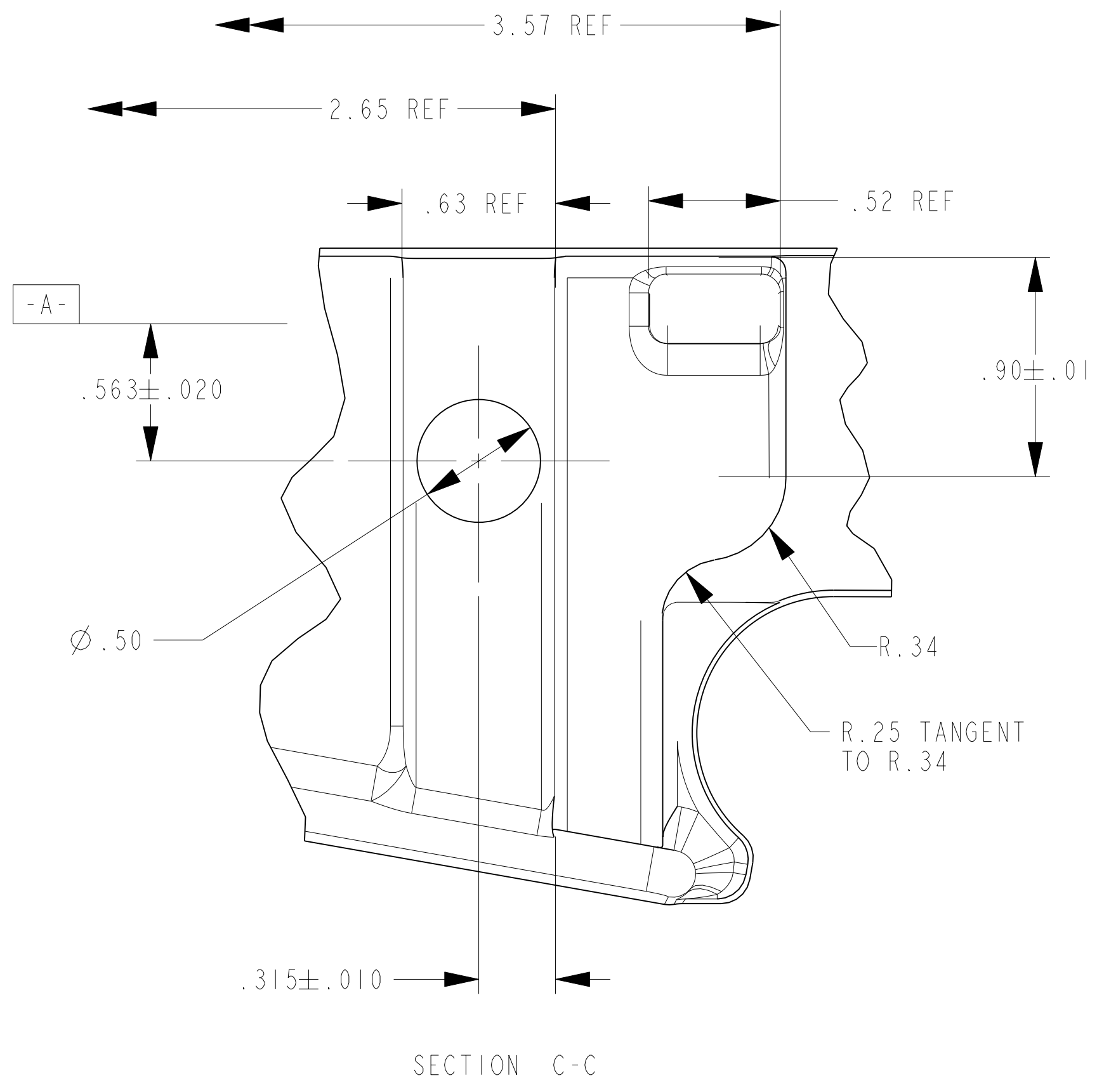
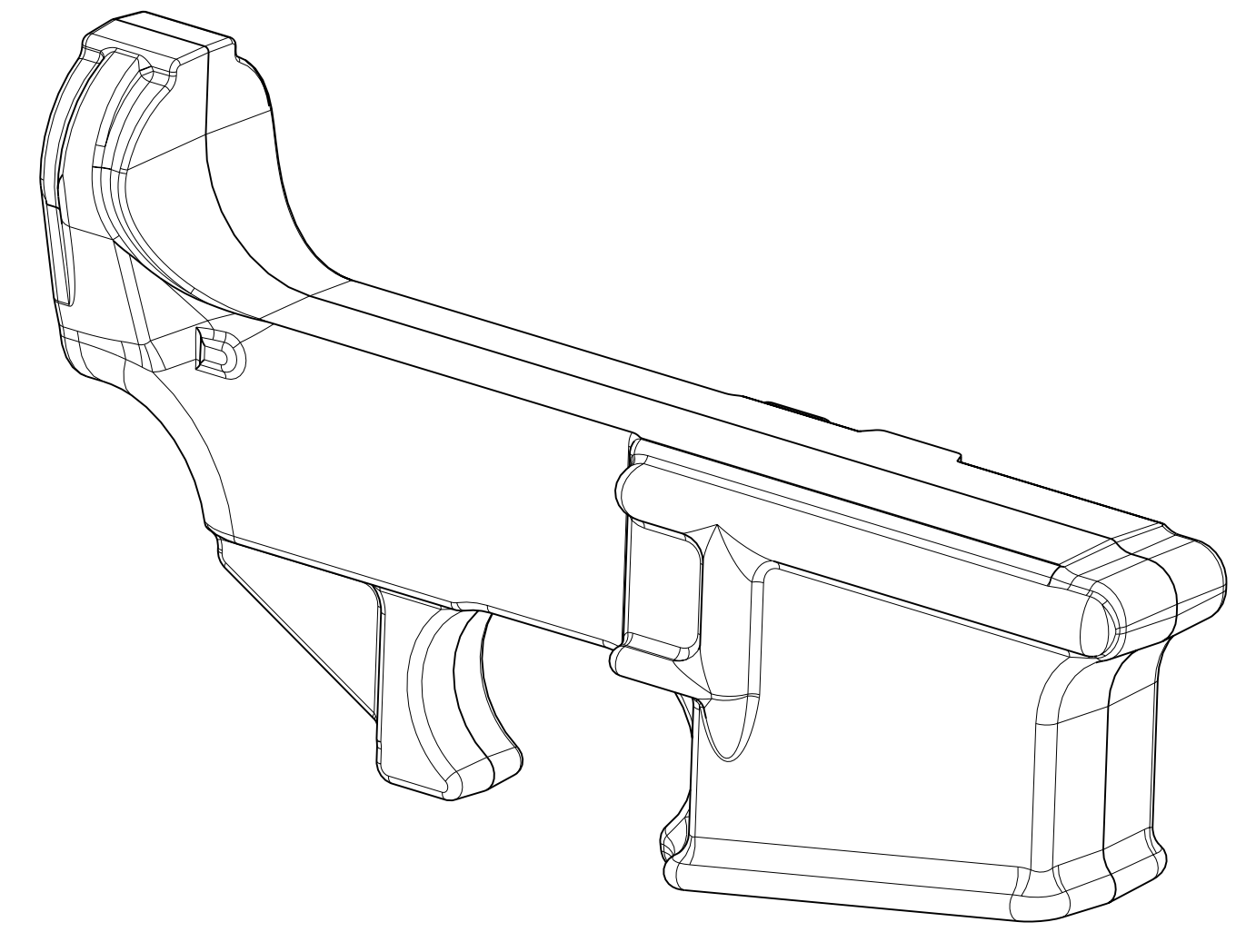
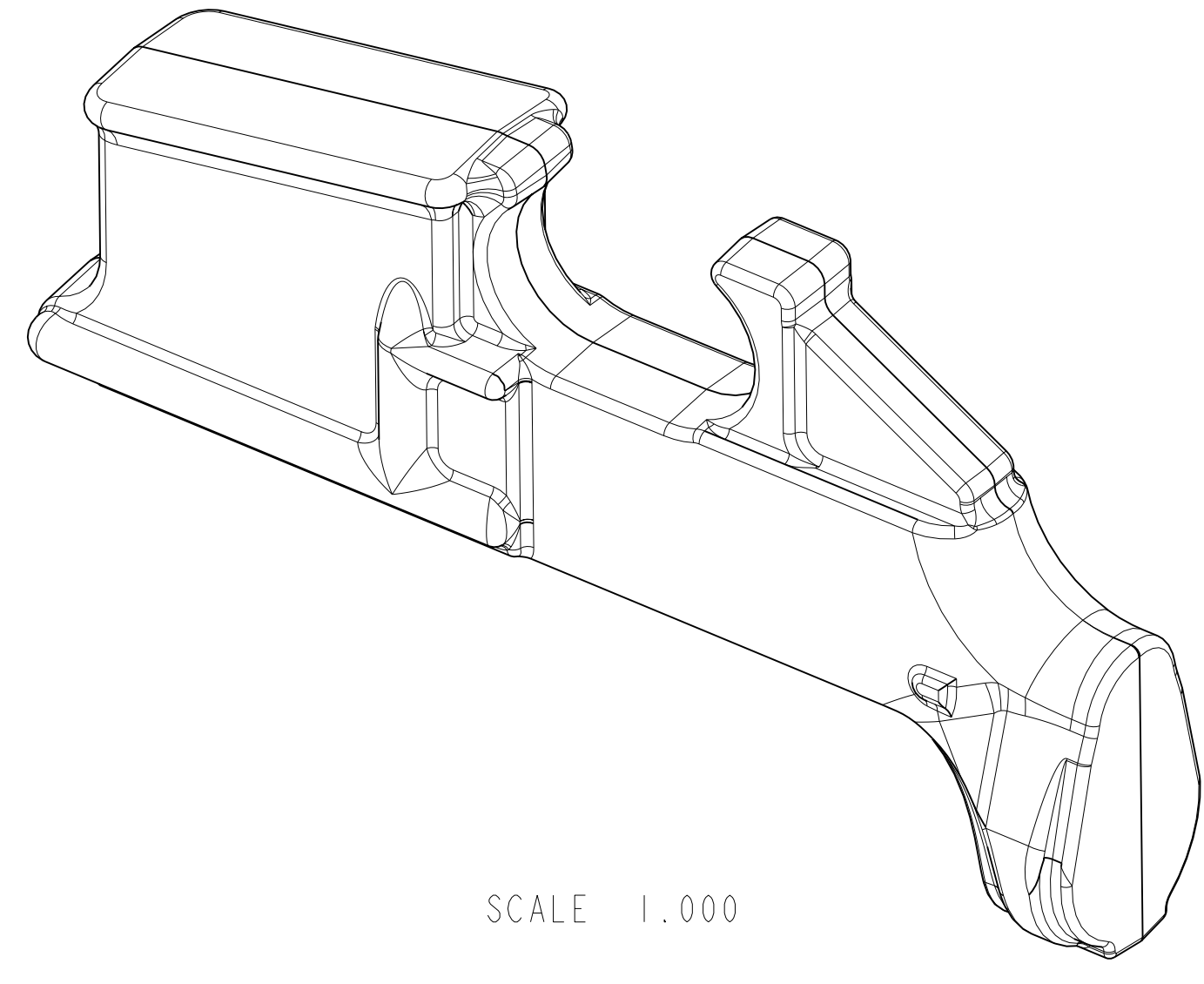
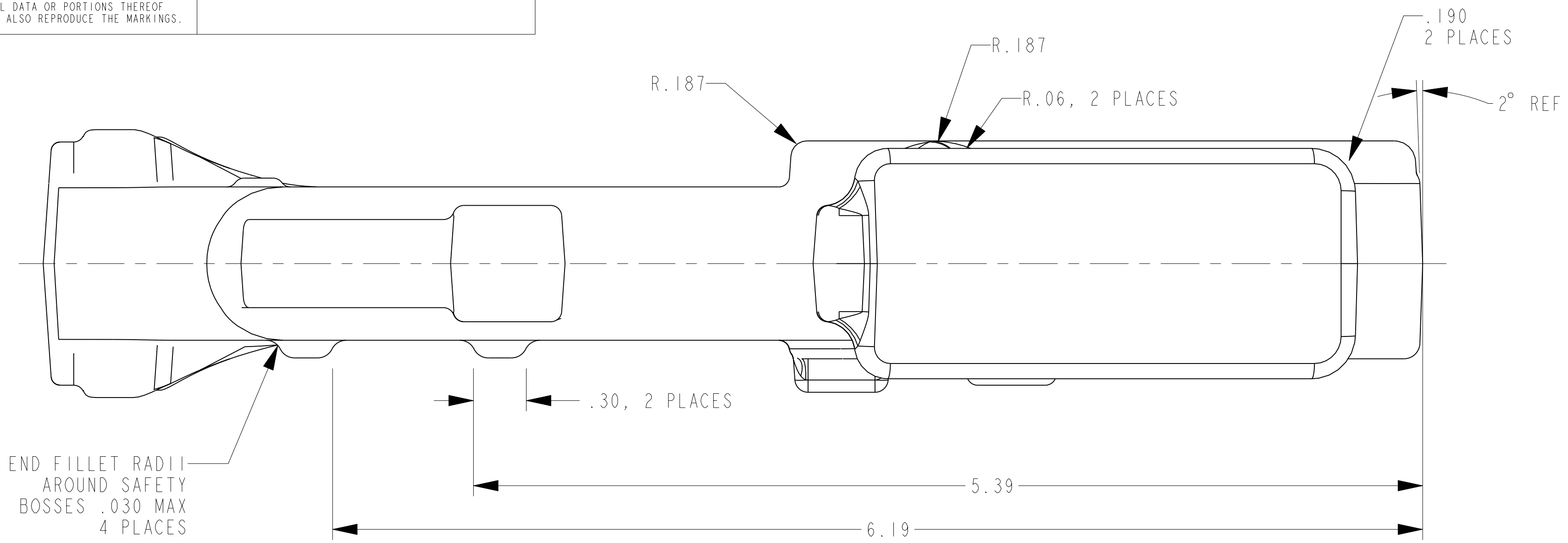

VIEW H
 ALTERNATE CONFIGURATION
 SCALE 4.000
 (ZONE C3, SH.1)

SECTION D-D
 SCALE 10.000
 (ZONE C3, SH.1)

SECTION E-E
 (ZONE B7, SH.1)

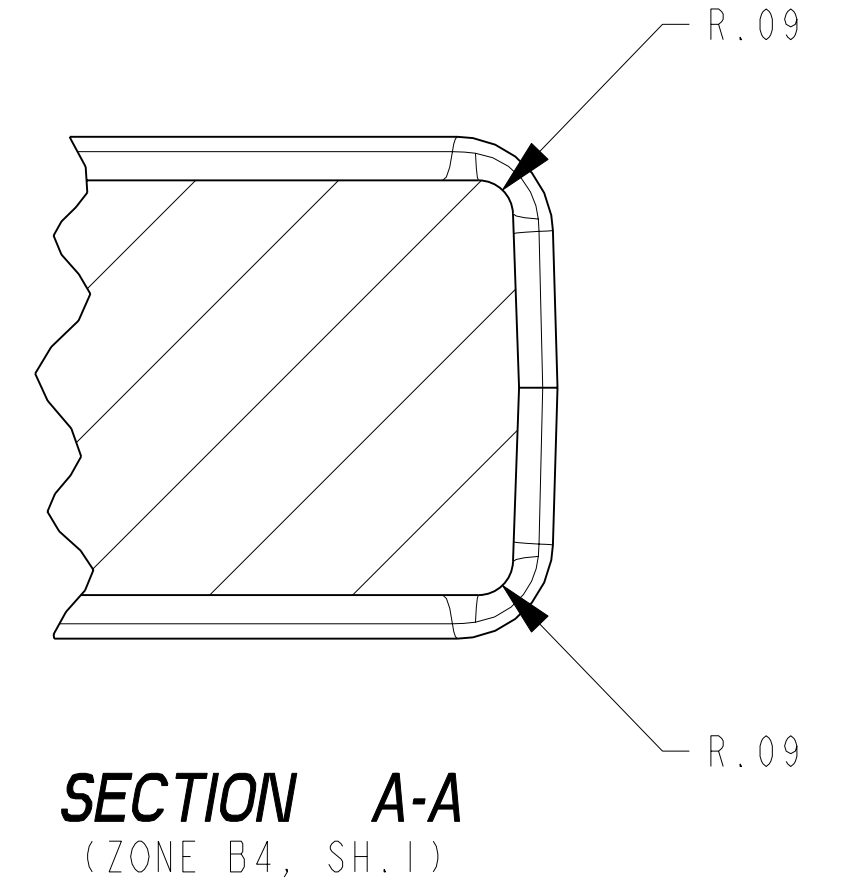
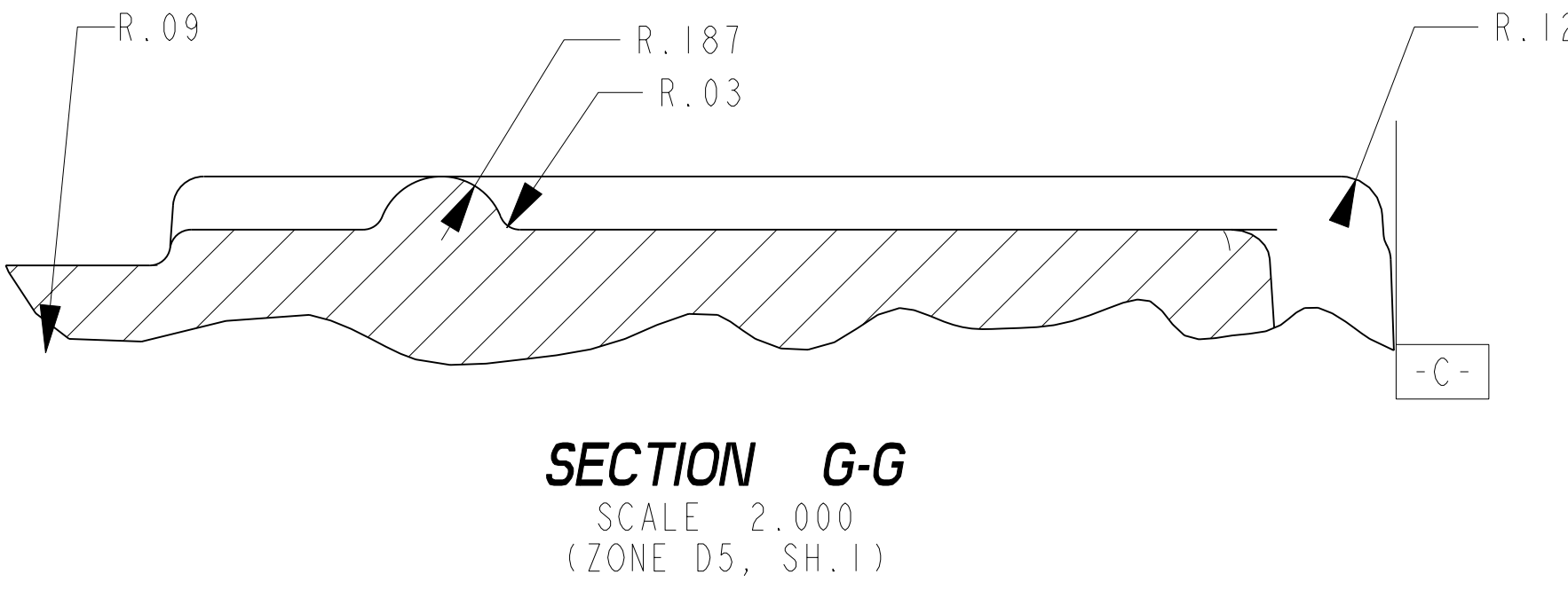

SECTION G-G
 SCALE 2.000
 (ZONE D5, SH.1)

SECTION A-A
 (ZONE B4, SH.1)

THIS DRAWING WAS GENERATED FROM A SOLID MODEL AND IS CAD MAINTAINED. CHANGES SHALL BE INCORPORATED BY THE DESIGN ACTIVITY.

PART NO. 8448641

DISTRIBUTION STATEMENT F: FURTHER DISTRIBUTION ONLY AS DIRECTED BY US ARMY; ARDEC, AMSTA-AR-CCL-F, ROCK ISLAND, IL; 1993-09-14.

PMIC			DO NOT SCALE DRAWING	CONTRACT NUMBER	DESIGN ACTIVITY
		M231	UNLESS OTHERWISE SPECIFIED DIMENSIONS ARE IN INCHES		US ARMY
		M4A1		CONTRACTOR	ROCK ISLAND ARSENAL
		M4	TOLERANCES ON ANGLES ± °		ROCK ISLAND, ILLINOIS
		8448608	2 PLACE DECIMALS ±	DRAWN BY	
		M16A4	3 PLACE DECIMALS ±	J. NELSON-ESERV	1970-04-27
YP		F9327036		CHECKER	ENGINEER
TS		M16A3		J. MACON-ESERV	J. WINDHAM
EL2		M16A2		ENGINEER	QUALITY ENGINEER
RA		M16A1	THIRD ANGLE PROJECTION	L. KO	E. SESE
		F8448608		DRAWING APPROVAL	
BH		M16A1		L. BRUNTON	2002-08-05
		NEXT ASSY		DESIGN APPROVAL	
RH		USED ON		R. ELBE	2002-08-05
		APPLICATION			

LOWER RECEIVER FORGING

SIZE **F** CAGE CODE 19204 DWG NO. 8448641

SCALE 2 UNIT WT. 1.503 SHEET 2 OF 2