

NOTICE: RESTRICTED AS TO USE AND DISCLOSURE

THIS ENTIRE DOCUMENT AND ALL INFORMATION IS PROPRIETARY TO COLT INC. AND SHALL NOT BE REPRODUCED, DUPLICATED OR COPIED IN WHOLE OR IN PART, DISCLOSED OR MADE AVAILABLE TO ANY OTHER PERSON, FIRM, OR CORPORATION OR OTHERWISE USED EXCEPT TO THE EXTENT NECESSARY FOR AND THEN ONLY IN CONNECTION WITH THE PREPARATION CONNECTION WITH THE PREPARATION AND/OR SUBMISSION OF BIDS OR PROPOSALS RELATED TO A PROCUREMENT BEING EFFECTED BY THE UNITED STATES EITHER BY THE UNITED STATES GOVERNMENT OR UNDER CONTRACT WITH THE UNITED STATES GOVERNMENT. THIS DOCUMENT WILL BE DISPOSED OF IN ACCORDANCE WITH THE INSTRUCTIONS ISSUED BY THE RESPONSIBLE CONTRACTING OFFICER UPON COMPLETION OF THE PURPOSE FOR WHICH IT WAS ISSUED.

SPECIAL LICENSE RIGHTS THE GOVERNMENT'S RIGHTS TO USE, MODIFY, REPRODUCE, RELEASE, PERFORM, DISPLAY, OR DISCLOSE THESE DATA ARE RESTRICTED BY CONTRACT NO. DAAF03-67-C-108, LICENSE NO. DAAF03-67-C-108. ANY REPRODUCTION OF TECHNICAL DATA OR PORTIONS THEREOF MARKED WITH THIS LEGEND MUST ALSO REPRODUCE THE MARKINGS.

DUE TO GOVERNMENT GENERATED ENGINEERING CHANGES, THERE MAY BE DATA AND/OR TOLERANCES NOT PROPRIETARY TO COLT'S.

REVISIONS				
MODEL REV	DRAWING REV	DESCRIPTION	DATE(YEAR-MO-DA)	APPROVED
N/A	G	NOR GIS2018 / 1991-02-08	1991-10-11	
-	H	NOR LIS3057 / 2001-11-19	2002-06-12	JJW
A	J	NOR L06S3020 / 2006-03-29	2006-05-02	BMG

NOTES

- MATERIAL: ALUMINUM ALLOY, 7075-T6 QQ-A-225/9.
- SURFACE FINISH 125/.
- GRIT BLAST CONTOURED O.D. PRIOR TO FINISH TO PRODUCE NON REFLECTIVE MATTE SURFACE AFTER FINISH.
- FINISH MIL-A-8625, TYPE 3, CLASS 2, FILM THICKNESS .0010±.0002, FINISH SHALL BE LUSTERLESS(FLAT), APPROX. BLACK, NO. 37038, TABLE IX BUT NOT LIGHTER THAN GRAY, NO. 36076, TABLE OF FED-STD-595, AND SEAL.
- BREAK SHARP EDGES .005 MAX.
- ALL DIAMETERS $\oplus .010 \text{ (M) } \text{C}$
- ALL DIMENSIONS APPLY BEFORE FINISH.
- QUALITY ASSURANCE PROVISION REQUIREMENTS PER DRAWING NUMBER 12993884 APPLY.

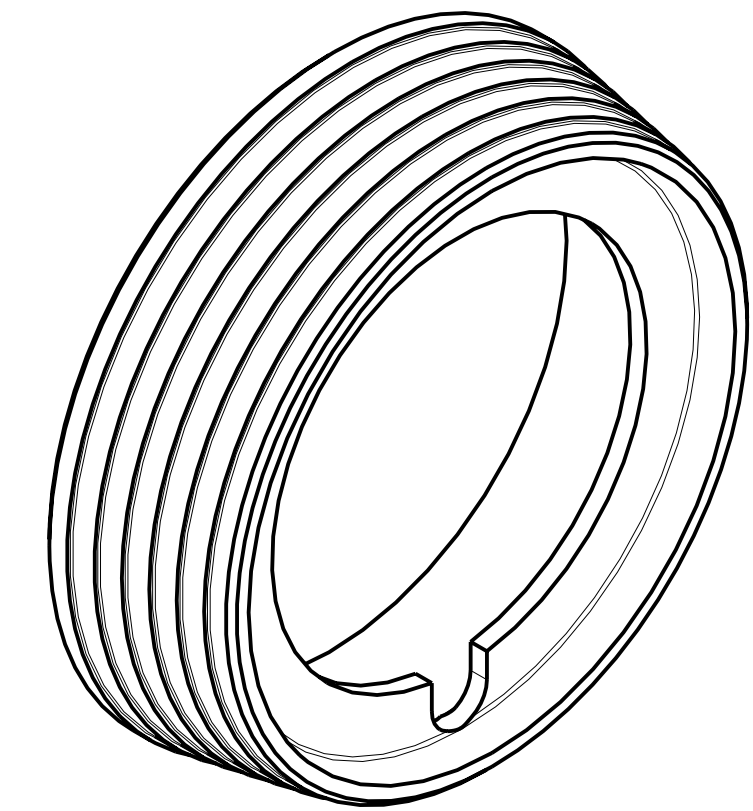
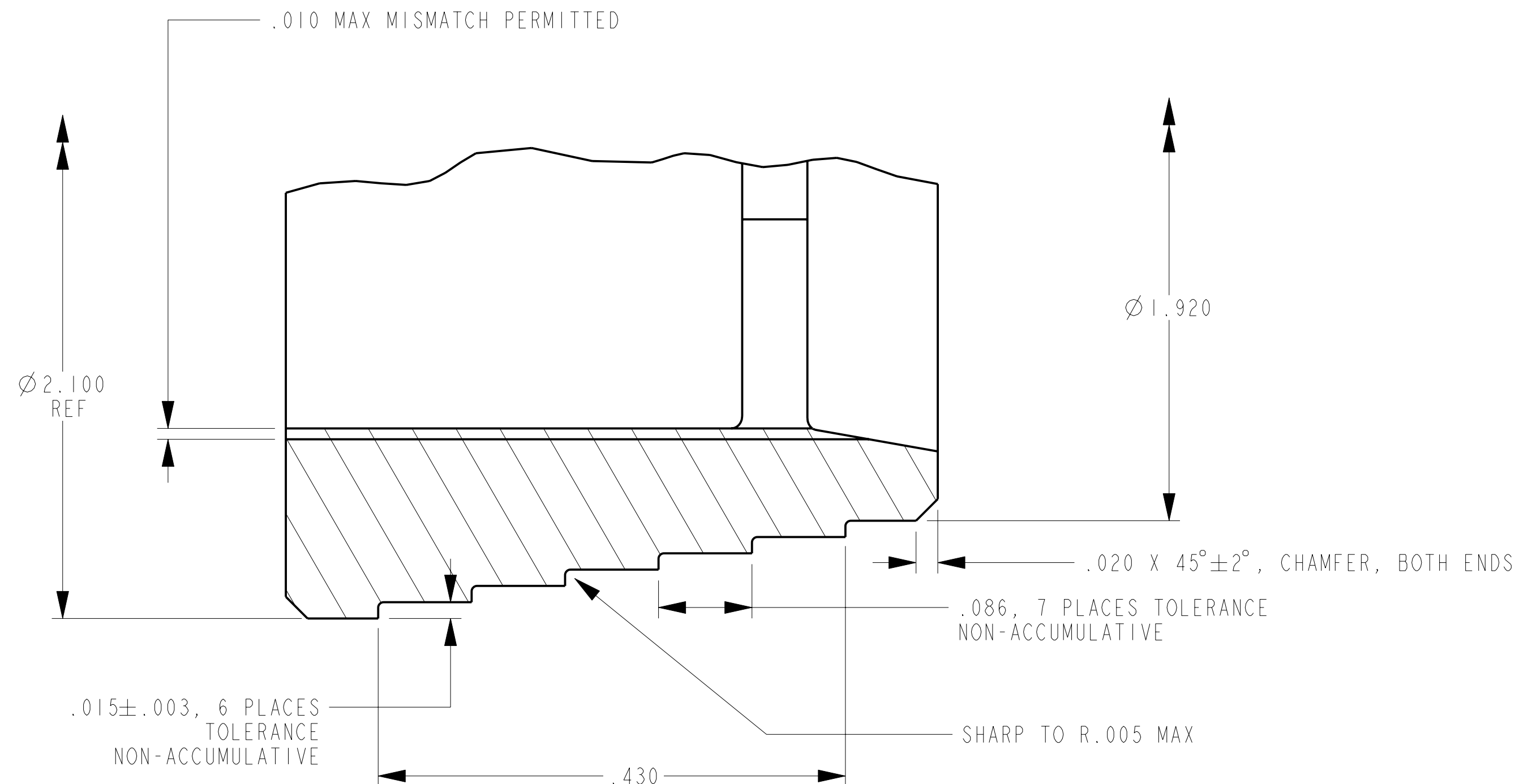
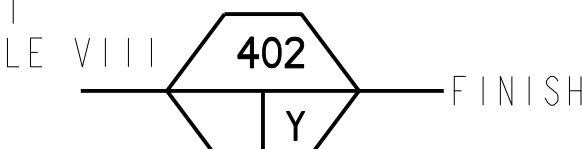
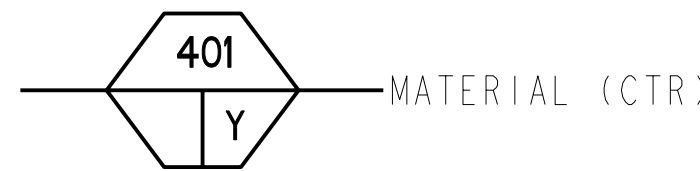

DETAIL F SCALE 10.000

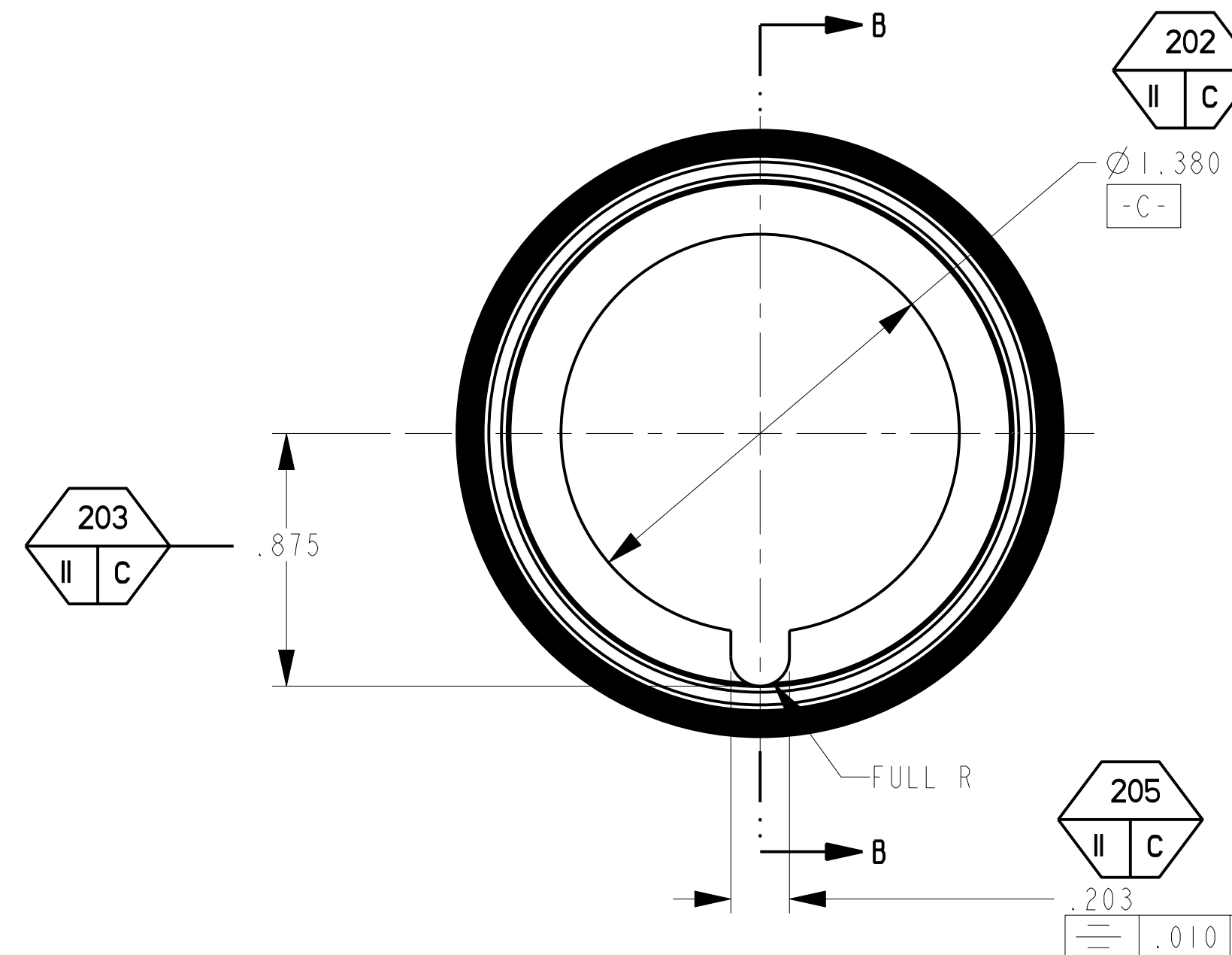
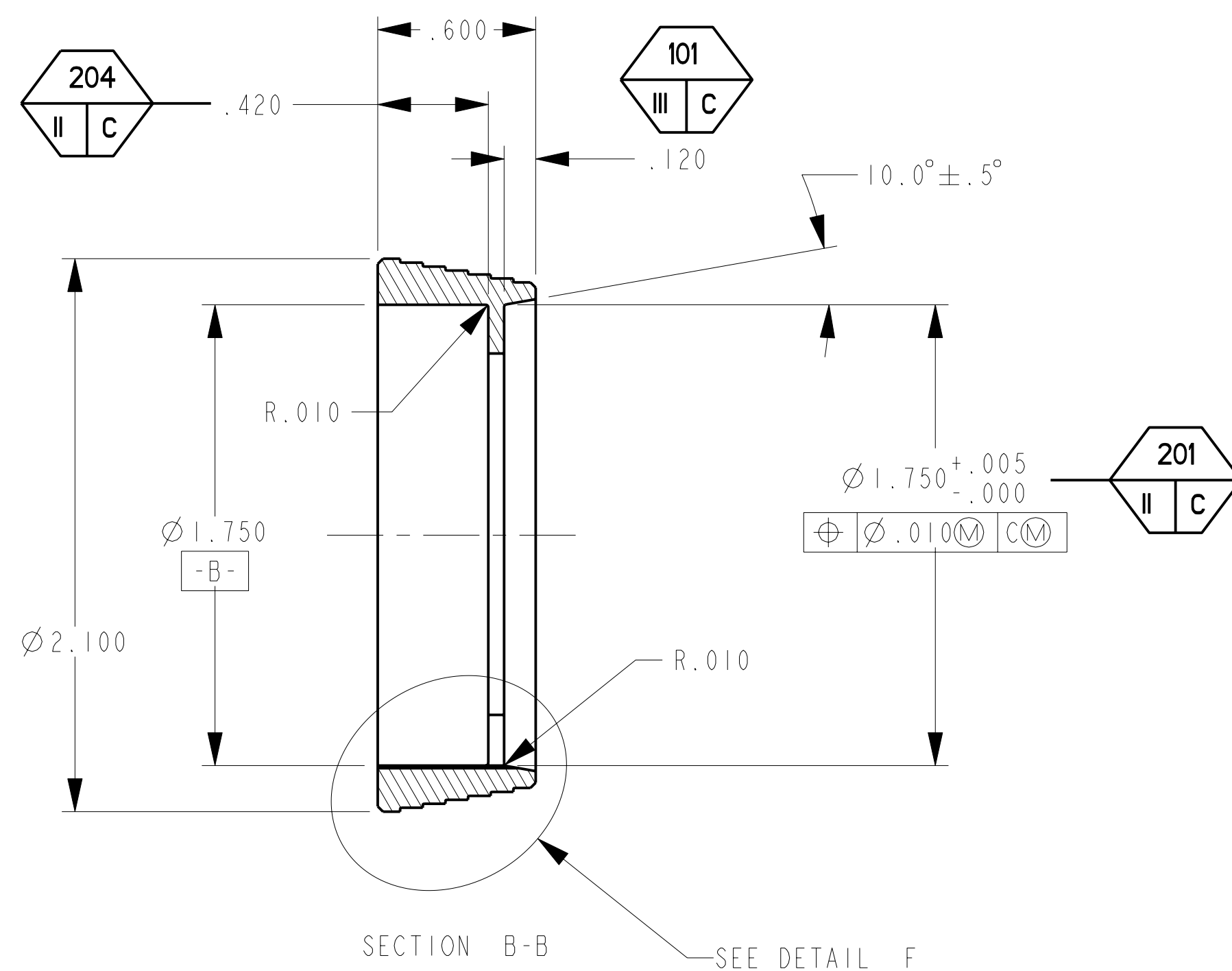
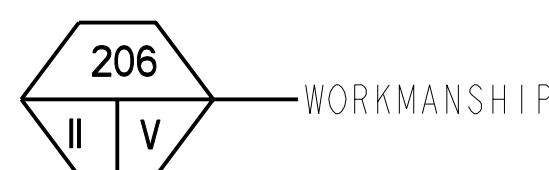

CURRENT DESIGN ACTIVITY CAGE CODE 19200
US ARMY
ARMAMENT RESEARCH, DEVELOPMENT AND ENGINEERING CENTER
PICATINNY ARSENAL, NEW JERSEY 07806-5000

THIS DRAWING WAS GENERATED FROM A SOLID MODEL AND IS CAD MAINTAINED. CHANGES SHALL BE INCORPORATED BY THE DESIGN ACTIVITY.

PART NO. 8448712

DISTRIBUTION STATEMENT F:
FURTHER DISTRIBUTION ONLY AS DIRECTED BY US ARMY ARDEC;
AMSTA-AR-CCL-F, ROCK ISLAND, IL; 1993-09-14.

PMIC	8448711		M4A1	DO NOT SCALE DRAWING UNLESS OTHERWISE SPECIFIED DIMENSIONS ARE IN INCHES	CONTRACT NUMBER	DESIGN ACTIVITY	
	M4		M4		CONTRACTOR	US ARMY ROCK ISLAND ARSENAL ROCK ISLAND, ILLINOIS	
MECHANICAL PROPERTIES	M16A4		M16A4	TOLERANCES ON ANGLES ± ° 2 PLACE DECIMALS ± 3 PLACE DECIMALS ± .005	DRAWN BY	DATE(YEAR-MO-DA)	SLIP RING, HAND GUARD
YP	M16A3		M16A3	THIRD ANGLE PROJECTION	T. KULIG - ESERV	1970-04-27	
TS	M16A2		M16A2		CHECKER	ENGINEER	
EL2	M16A1		M16A1		G. STRAHL	J. WINDHAM	
RA	B8448711		M16A1	MATL ENGR	MODELED BY	DESIGN APPROVAL	
BH	NEXT ASSY		USED ON	R. ELBE	S. GALL - ESERV	R. ELBE	
RH	APPLICATION						

SIZE	CAGE CODE	DWG NO.
D	19204	8448712
SCALE	UNIT WT.	SHEET
2/1	0.050	1 OF 1